

FAG

6022-2Z

Deep groove ball bearing

Schaeffler ID:
0167184530000Deep groove ball bearing 60...-2Z, single
row, shields, steel sheet metal cage

Technical information

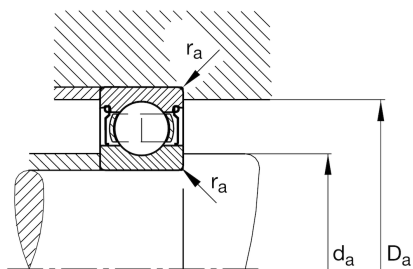
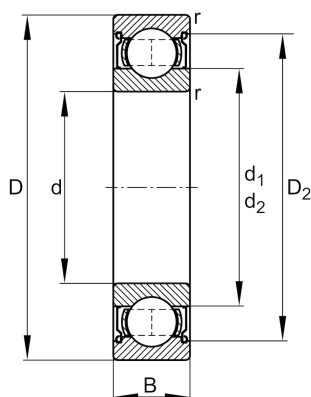
**Main Dimensions & Performance Data**

d	110 mm	Bore diameter
D	170 mm	Outside diameter
B	28 mm	Width
C_r	85.000 N	Basic dynamic load rating, radial
C_{0r}	71.000 N	Basic static load rating, radial
C_{ur}	3.550 N	Fatigue load limit, radial
n_G	4.550 1/min	Limiting speed
n_{gr}	4.850 1/min	Reference speed
	2,11 kg	Weight

Dimensions

r_{min}	2 mm	Minimum chamfer dimension
D_2	155 mm	Caliber diameter outer ring
d_1	128,7 mm	Shoulder diameter inner ring

Mounting dimensions

$d_{a min}$	118,8 mm	Minimum diameter shaft shoulder
$D_{a max}$	161,2 mm	Maximum diameter of housing shoulder
$r_{a max}$	2 mm	Maximum fillet radius

Calculation factors

f_0	15,7	Calculation factor
-------	------	--------------------

Temperature range

T_{min}	-20 °C	Operating temperature min.
T_{max}	120 °C	Operating temperature max.